

ALL these details to be read in conjunction with Technical Bulletin Reference Number MRC/FR/SF/PDHW/BU/001

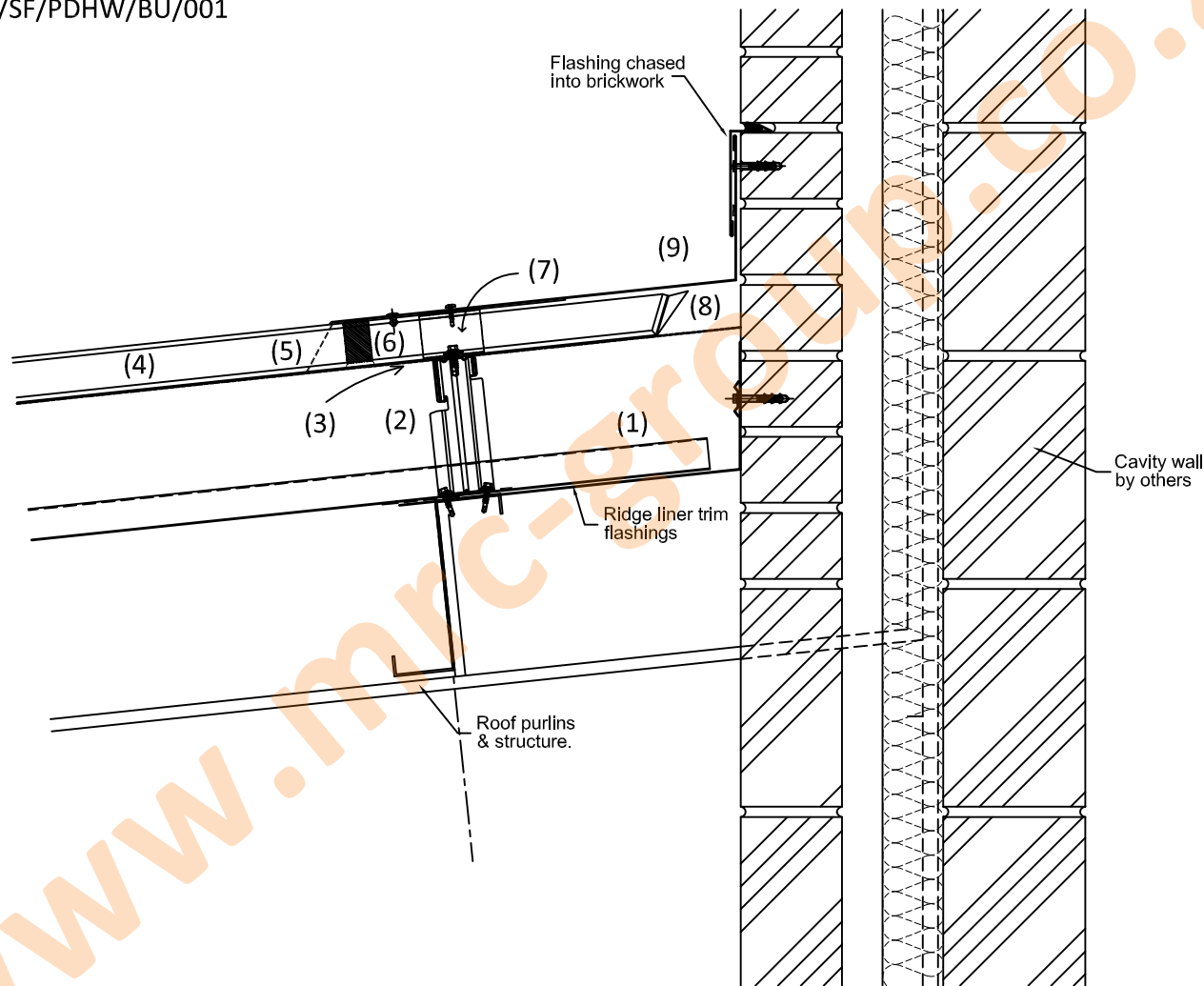

SYSTEM SPECIFICATION.

- (1) MRC Liner Sheet or existing roof sheeting as per specification.
- (2) Ashgrid Bar & Bracket Spacer Support System with Thermal Pad & Fixings as per specification.
- (3) Optional Thermal Insulation as per specification, if not used then a MRC Breather Membrane to be installed between the Ashgrid and the 'Secret Fix' Clip.
- (4) MRC 'Secret Fix' Roof Sheeting and associated clip as per specification.
- (5) Ridge Serrated Metal Closure as per specification.
- (6) Ridge Polyclosure complete with mastic seal as per specification.
- (7) MRC 'Secret Fix' clip as per Specification.
- (8) 'Turn Up' off the MRC 'Secret Fix' Roof Sheeting as per specification.
- (9) Headwall Flashing complete with angled metal counter flashing as per specification.

Rev	Date	Initial	Description

Drawing Title : Headwall to Brickwork		Project : MRC Group 'Secret Fix' Built Up Roof Construction With Liner Sheet	
Drawn : MRC	Date : 08/2015	Scale : 1:5 @ A3	Check :
Drawing No. : MRC/FR/SF/PDHW/BU/DWG001			Rev :

GENERAL NOTES.

- 1). Do not scale from this drawing.
- 2). All dimensions shown on this drawing are in millimetres (mm) and are nominal unless marked.
- 3). Isolate all interfaces between dissimilar materials.
- 4). All details backed by the 'Guardian' System Warranty.



MRC Systems (PTY) Ltd  
Offices: Johannesburg, Durban, Cape Town

This drawing is copyright and is issued on the express condition that it is not to be copied or disclosed by or to any unauthorised person or firms without prior consent in writing from MRC Group.